

## LL Female Screw Elbow

CAD

RoHS compliant

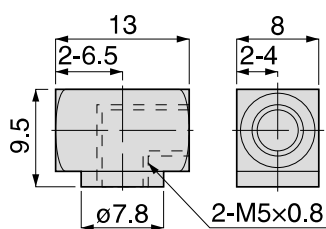

Unit : mm

Model code	Weight (g)	CAD file name
LL-FM5□	5.5	TFMF-002

※ □ in Model code / Replaced with "C" for Clean-room package

## LE Female Screw Tee

CAD

RoHS compliant

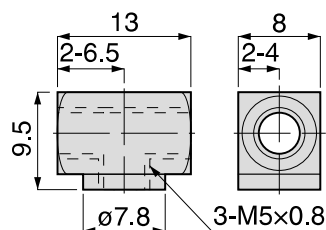

Unit : mm

Model code	Weight (g)	CAD file name
LE-FM□	5.5	TFMF-002

※ □ in Model code / Replaced with "C" for Clean-room package

## LN Male Screw Union

CAD

RoHS compliant

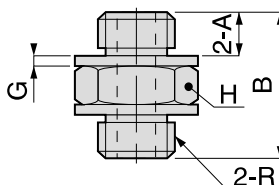

Unit : mm

Model code	R	A	B	G	Hex. H	Weight (g)	Orifice dia.	Effective area (mm <sup>2</sup> )	CAD file name(※3)
LN-M3-M3□	M3 × 0.5	2.5 [2.2]	8	0.5 [0.8]	5.5	0.7	1.2	1.0	—
LN-M5-M5□	M5 × 0.8	3 [3.2]	9.5	0.5 [0.3]	7	1.5	2.5	2.1	TFMF-002

※ 1. □ in Model code / Replaced with "C" for Clean-room package

※ 2. Dimensions in [ ] are for clean-room package products.

※ 3. Visit PISCO website for CAD data of clean-room package products.